

KidTrax™

Adult Assembly Required

**Please retain these instructions
for future reference**

Ages: 2 years to 4 years

Sidekick Scooter

Model KT1055

User Guide



www.kidtraxtoys.com
customerservice@kidtraxtoys.com

Kid Trax Toys
PO Box 344, Olney, IL 62450

Toll-free (877) 741-6154
8 am to 5 pm Monday thru Friday CST

©2008 Pacie Cycle Inc.
Styles and colors may vary
Made in CHINA to Pacie Cycle Inc. quality specifications

PN KT1055PM-01 04.2008

Table of Contents

About Your New Sidekick Scooter	1
Service and Repairs	1
Parts List.....	2
Attach Front Wheel	3
Install Handlebar Assembly.....	4
Install Storage Compartment	4
Charge 6-volt Battery Prior to First Use	5-7
Using the Sidekick Scooter	8
Rules for Safe Riding	9
Get to Know Your Sidekick Scooter	10
Power Switch.....	11
Shift Switch	11
Foot Pedal	11
Driving the Sidekick Scooter.....	12
Approximate Riding Time with a Fully-Charged Battery	13
Battery Maintenance	14
Replacing the Battery.....	15
Maintaining Your Sidekick Scooter	16
Troubleshooting Guide.....	17-19
Replaceable Parts	20
One-Year Limited Warranty/Six-Month Limited Warranty on Battery.....	21

About Your New Sidekick Scooter

Thank you for purchasing the Kid Trax Sidekick Scooter. Kid Trax wants your child to enjoy this product for years to come. Keep these points in mind as you read this guide:

- **This Sidekick Scooter ride-on is recommended for children ages 2 years to 4 years. Maximum combined weight is 50 lbs. (22.7 kg).**
- **ADULT SUPERVISION REQUIRED!**
- 6-Volt battery must be charged prior to first use (see pages 5-7).
- Children must follow safety rules for riding (see page 9).
- Read and explain operating instructions to your child (see pages 10-13).
- **ADULTS ONLY:** Recharge battery according to directions (see pages 5-7) and maintain battery(see page 14).

WARNING!

FOR THE SAFETY OF YOUR CHILD, PLEASE READ ALL WARNINGS AND ASSEMBLY/USE INSTRUCTIONS. KEEP THIS GUIDE FOR FUTURE REFERENCE.

- **ADULT ASSEMBLY REQUIRED.** The product contains small parts, which are for adult assembly only. Keep small children away when assembling.
- Always remove protective material and poly bags and dispose before assembly. Be sure to remove all packing materials and parts from underneath the car body.
- This product contains or emits chemicals known to the State of California to cause cancer and birth defects or other reproductive harm.

CAUTION!

- Park the Sidekick Scooter indoors or cover it with a tarp to protect it from wet weather. Do not leave vehicle in sun for long periods of time or fading may occur. Store in shade or cover with tarp.
- Do not drive the Sidekick Scooter in loose dirt, sand or fine gravel, which could damage moving parts, motors or the electric system, which could void the warranty.
- Do not wash the Sidekick Scooter with a hose. Do not wash the Sidekick Scooter with soap and water. Do not drive the Sidekick Scooter in rainy or snowy weather. Water will damage the motor, electric system and battery.

Service and Repairs

- Do not return this product to the place of purchase.
- Lay out and identify all parts before assembly. If any parts are missing, call Kid Trax Toys Consumer Relations toll-free at (877) 741-6154, 8:00 am to 5:00 pm Monday thru Friday CST, e-mail us at customerservice@kidtraxtoys.com, or visit our web site at www.kidtraxtoys.com.
- Provide the serial number, found underneath the Sidekick Scooter's seat on the car body and a brief description of the part.
- If your Sidekick Scooter needs service or repairs, call Kid Trax Toys Consumer Relations at (877) 741-6154 for an authorized service center.

Parts List

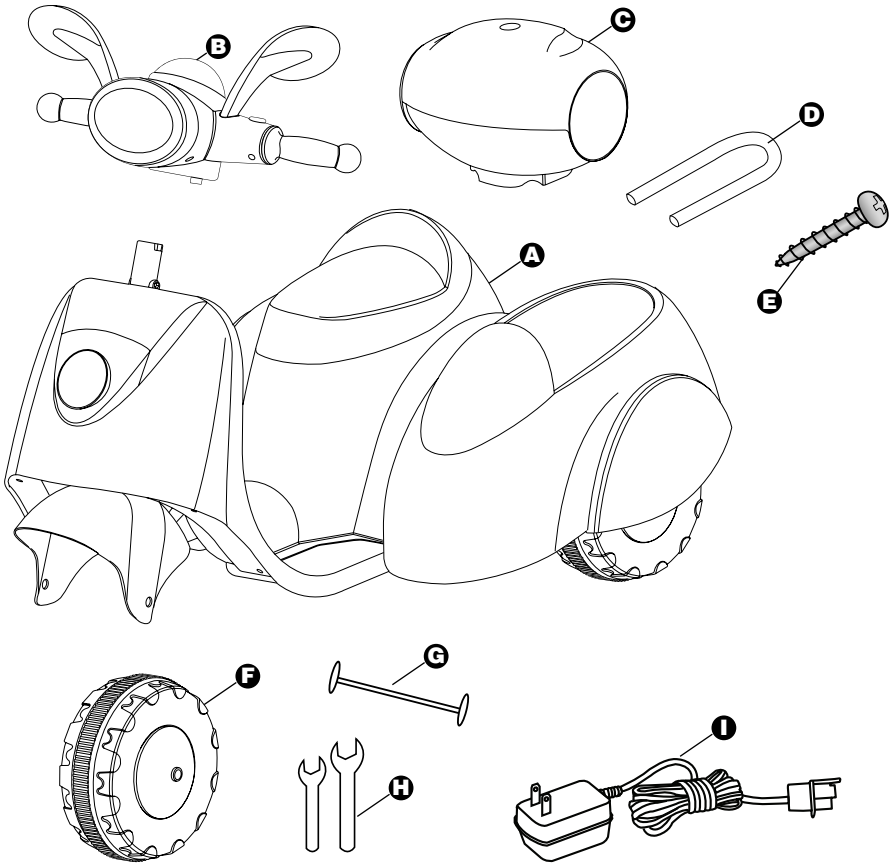

- A** Main Body
- B** Handlebar Assembly
- C** Storage Compartment
- D** U-tube support
- E** 3 Screws
- F** Front Wheel
- G** Front Wheel Axle
- H** 2 Wrenches
- I** Charger

Tools needed for assembly:

- Phillips screwdriver

Attach Front Wheel

Carefully remove all items from the packaging and ensure that you have all parts. If you do not have all pieces please call our customer service number to order replacement parts.

1. Use the wrench provided to remove the axle nut, lock washer and washer from one end of the wheel axle.
2. Look inside the front fender and locate the rubber packing covers on both ends of the fork. Pull the covers off and discard.
3. Position the front wheel inside the front fender, holding the wheel covers in place. Insert the wheel axle through the fender, fork and front wheel, then through the other side of the fork and fender.

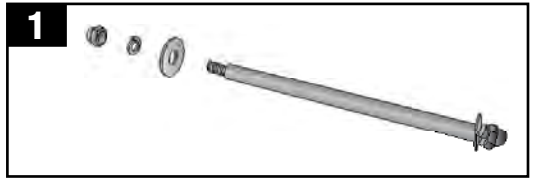

4. Replace the washer, lock washer and axle nut onto the wheel axle.

IMPORTANT! Tighten the axle nuts using the two wrenches supplied.

Periodically tighten the axle nuts to ensure the wheel is securely attached to the scooter.

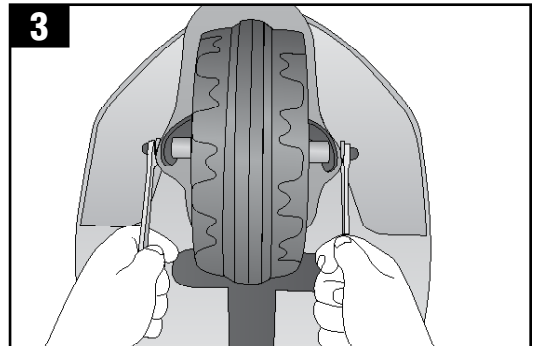
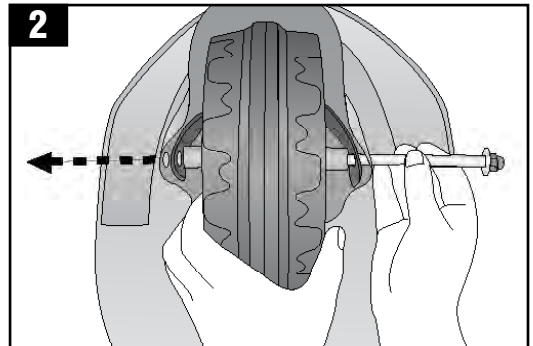

Install Handlebar Assembly

1. Connect the wiring connector from the handlebar assembly to the connector in the scooter body.

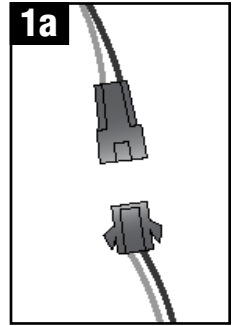
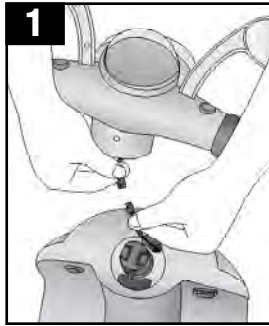

2. Lower the handlebar assembly onto the post of the scooter body. Push down until you hear a “click”. Pull up to make sure the handlebar is firmly attached.

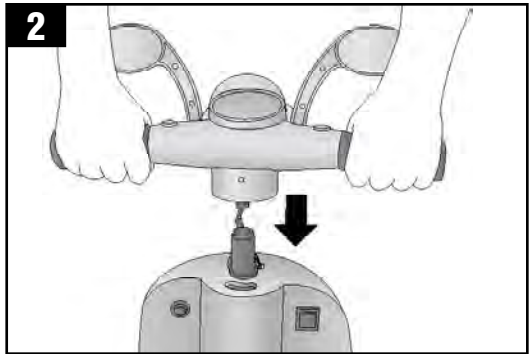

Install Storage Compartment

1. Insert the two metal rods of the storage compartment into the rear of the scooter until you hear a “click”. Pull back on the storage compartment to make sure it is firmly attached.

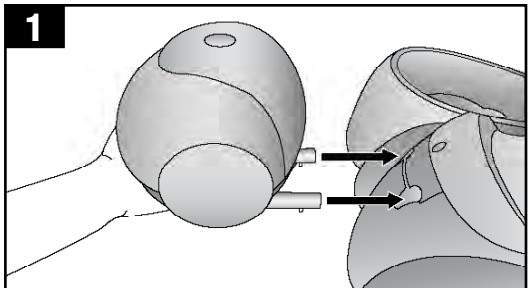

Charge 6-Volt Battery Prior to First Use

YOU MUST CHARGE THE 6-VOLT BATTERY FOR A FULL 24 HOURS PRIOR TO FIRST USE. FAILURE TO CHARGE THE BATTERY AS DIRECTED WILL CAUSE PERMANENT DAMAGE TO THE BATTERY AND VOID YOUR WARRANTY. After each use, or once a month minimum, charge the battery for a full 16 hours. Do not leave the battery on the charger for more than 30 hours. Read the following warnings before charging the battery.

WARNING!

• **PREVENT FIRE AND ELECTRIC SHOCK:**

- Use only the Kid Trax Toys 6-volt rechargeable battery and charger supplied with your vehicle. NEVER substitute the battery or the charger with another brand. Using another 6-volt battery or charger may cause a fire or explosion.
- Do not use the 6-volt battery or charger for any other product. Overheating, fire or explosion could occur.
- NEVER modify the electric circuit system. Tampering with the electric system may cause a shock, fire or explosion or may permanently damage the system.
- Do not allow direct contact between 6-volt battery terminals. Fire or explosion can occur.
- Do not allow any type of liquid on the battery or its components.
- Explosive gases are created during charging. Do not charge near heat or flammable materials. Charge the 6-volt battery in a well-ventilated area ONLY.
- NEVER pick up the battery by the wires or charger. Damage can occur to the battery and may cause a fire. Pick up the battery by the case or handle ONLY.
- Charge the battery in a dry area ONLY.
- Battery posts, terminals and related accessories contain lead and lead compounds, chemicals known to the State of California to cause cancer and reproductive harm. **Wash hands after handling.**
- Do not open the 6-volt battery. Battery contains lead acid and other materials that are toxic and corrosive.
- Do not open the charger. Exposed wiring and circuitry inside case may cause electric shock.
- Only adults may handle or charge the battery. NEVER allow child to handle or charge the battery. 6-volt battery is heavy and contains lead acid (electrolyte).
- Do not drop the 6-volt battery. Permanent damage to the 6-volt battery could occur or cause serious injury.
- Before charging the 6-volt battery, check for wear or damage to the battery, charger, its supply cord and the connectors. DO NOT charge the 6-volt battery if any damage to parts has occurred. Replace with Kid Trax Toys parts ONLY.
- Do not allow the 6-volt battery to drain completely. Recharge the battery after each use or once a month if not used regularly.
- Do not charge battery upside down.
- Always secure the battery with the bracket. 6-volt battery can fall out and injure a child if vehicle tips over.

Charge 6-Volt Battery Prior to First Use, Continued

ONLY AN ADULT CAN CHARGE AND RECHARGE THE BATTERY. See pages 14-15 for battery maintenance and battery replacement.

NOTE: It is not necessary to remove the battery from the vehicle for charging. However, if the adapter cord will not safely reach a 120-volt wall outlet, the battery can be removed for charging.

1. Using a Phillips screwdriver, unscrew the seat screw.
NOTE: The screw will remain in the seat.

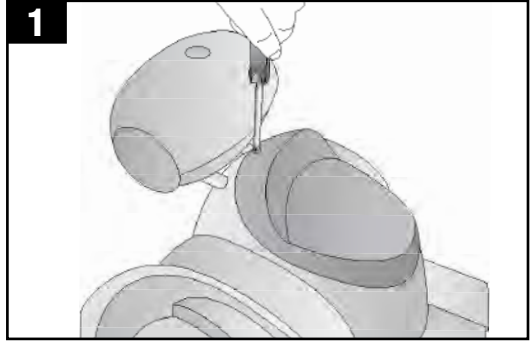

2. Lift seat off and set aside.

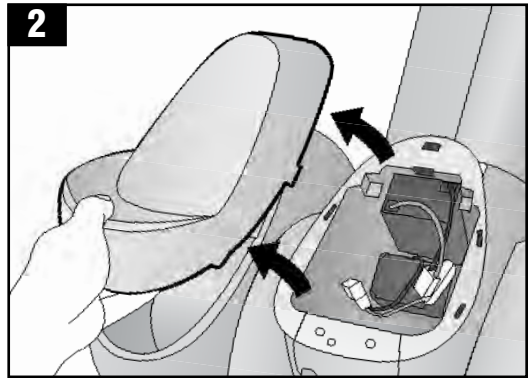

3. Plug the charger into the battery.

Use **ONLY** the 6-volt battery charger included with the vehicle (Input: AC 120V-, 0.35A, 60Hz Output: DC 6.0V, 0.6A).

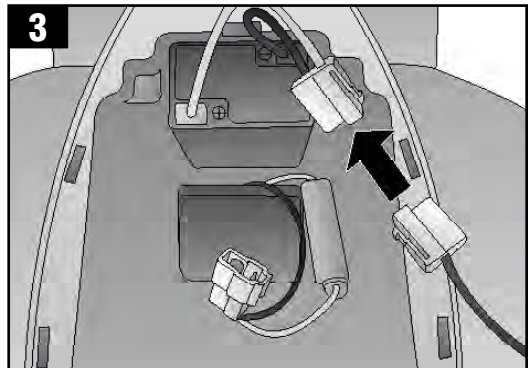

Charge 6-Volt Battery Prior to First Use, Continued

4. Plug the charger into a standard 120-volt wall outlet. The charger may feel warm during charging. This is normal and not a cause for concern.

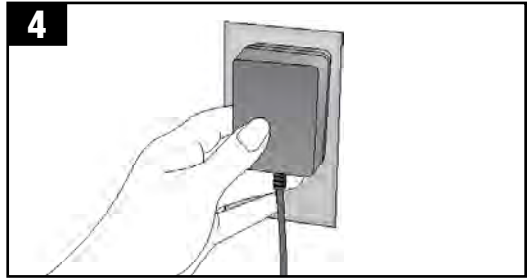

5. **ALLOW THE BATTERY TO CHARGE FOR A FULL 24 HOURS BEFORE THE FIRST USE.**

NOTE: When recharging the battery, allow the battery to charge for 16 to 18 hours.

6. After charging is complete, unplug the charger from the wall outlet, then unplug the charger connector from the scooter.
7. Plug the battery connector into the battery.

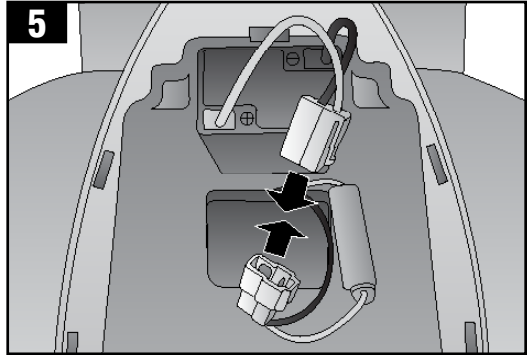

8. Fit the tabs of the seat into the scooter body and press down.

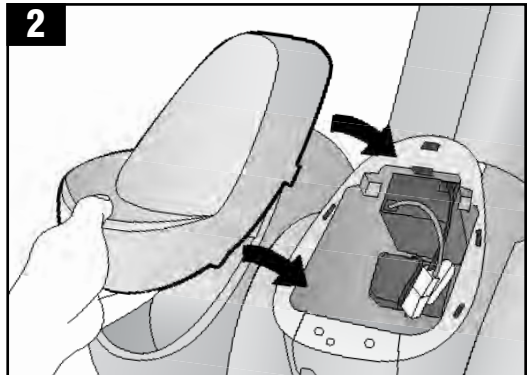

9. Tighten the seat screw using a Phillips screwdriver.

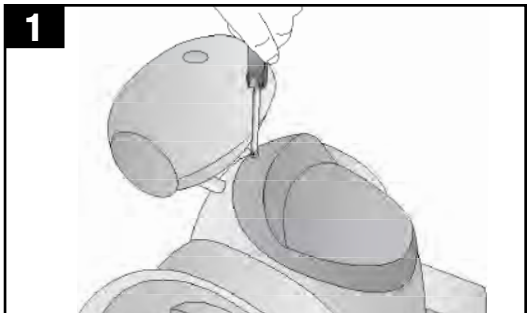

Using the Sidekick Scooter

WARNING!

PREVENT INJURIES AND DEATHS:

- **NEVER LEAVE CHILD UNATTENDED. DIRECT ADULT SUPERVISION IS REQUIRED.**

- Always keep child in view when child is in vehicle.
- Never use in roadways, near cars, on or near steep inclines or steps, swimming pools or other bodies of water.
- Always wear shoes.
- Always sit on the seat.
- Never allow more than one (1) rider in the vehicle.
- Weight maximum: 50 lbs. (22.7 kg).

- **The Kid Trax Toys Sidekick Scooter is for children aged 2 years to 4 years.**
- **MAXIMUM WEIGHT IS 50 LBS. (22.7 KG).** Do not overload the Sidekick Scooter. Do not tow anything behind the Sidekick Scooter. Damage to the motor or gears could occur, which could void the warranty.
- Your child will enjoy many happy hours riding the Kid Trax Sidekick Scooter. You, as the responsible adult, must supervise your child riding in the Sidekick Scooter!
- Your young child's judgment skills are still developing, and they may be tempted to drive the Sidekick Scooter into unsafe areas or in an unsafe manner. Always watch to see where your child is going, and that they handle the vehicle safely.
- Read the "Rules for Safe Riding" (page 9) out loud to your child and their playmates, and insist they follow the rules.
- Point out all the parts of the handlebars and the foot pedal to your child. Use the diagrams on page 10 to find the parts on the Sidekick Scooter.
- Show your child how to safely operate the Sidekick Scooter (pages 10-13).
- To prevent unsupervised riding in the Sidekick Scooter, disconnect or remove the battery (see page 15).

Rules for Safe Riding

READ THESE RULES ALOUD TO YOUR CHILD AND THEIR PLAYMATES AND MAKE SURE THEY UNDERSTAND THEM!

- **Always drive the Sidekick Scooter with an adult watching.**
- **Rider must be 2 years of age and less than 50 lbs.**
- **Always sit in the seat.**
- **Always wear shoes.**
- **Always shut off power before climbing in or out of vehicle.**
- **Only one rider in the Sidekick Scooter.** If more children ride on the scooter, they may fall off, or cause the Sidekick Scooter to tip over. Serious injury could occur! Also, the Sidekick Scooter may be overloaded, which could damage the motor or gears (weight maximum of 50 lbs. [22.7 kg]).
- **Do not drive near full-sized, motorized vehicles.** It is dangerous to drive the Sidekick Scooter on driveways, streets or alleys that are used by full-sized motorized vehicles. The Sidekick Scooter is small and may be out of sight to the driver of a full-sized car.
- **DRIVE ONLY ON LEVEL GROUND!** The Sidekick Scooter will operate best on concrete or other firm surfaces.
- **Never drive near water!** Do not drive toward a swimming pool, creeks or a pond! Drowning could occur.
- **Do not drive down a steep slope.** The Sidekick Scooter may go too fast, causing it to tip over or slip.
- **Do not drive up a steep slope.** The motor may stop and the Sidekick Scooter could roll backward and go too fast, causing it to tip over.
- **Do not drive near drop-offs, such as steps or decks.** The Sidekick Scooter could tip over.
- **Keep hands, hair and clothes away from moving parts,** such as the wheels or the motor. Serious injury could occur.
- **Do not drive near flammable vapors, such as gasoline, paint thinner or liquid wax that are usually stored in the garage.** The Sidekick Scooter's electric switch will spark when first turned on or when turned off and could cause an explosion or fire! Keep flammable products tightly sealed and stored away from the Sidekick Scooter.
- **Do not drive the Sidekick Scooter in rainy or snowy weather.** Water will damage the motor, electric system and battery. Poor traction may cause the Sidekick Scooter to slip or the wheels to spin, which could cause the power to shut down (see thermal fuse information in Battery Maintenance, page 14).
- **Do not drive the Sidekick Scooter in loose dirt, mud, sand or fine gravel, which can damage moving parts, motors or the electric system.** Poor traction could cause the Sidekick Scooter to slip or the wheels to spin, which could cause the power to shut down (see thermal fuse information in Battery Maintenance, page 14).

Get to Know Your Sidekick Scooter

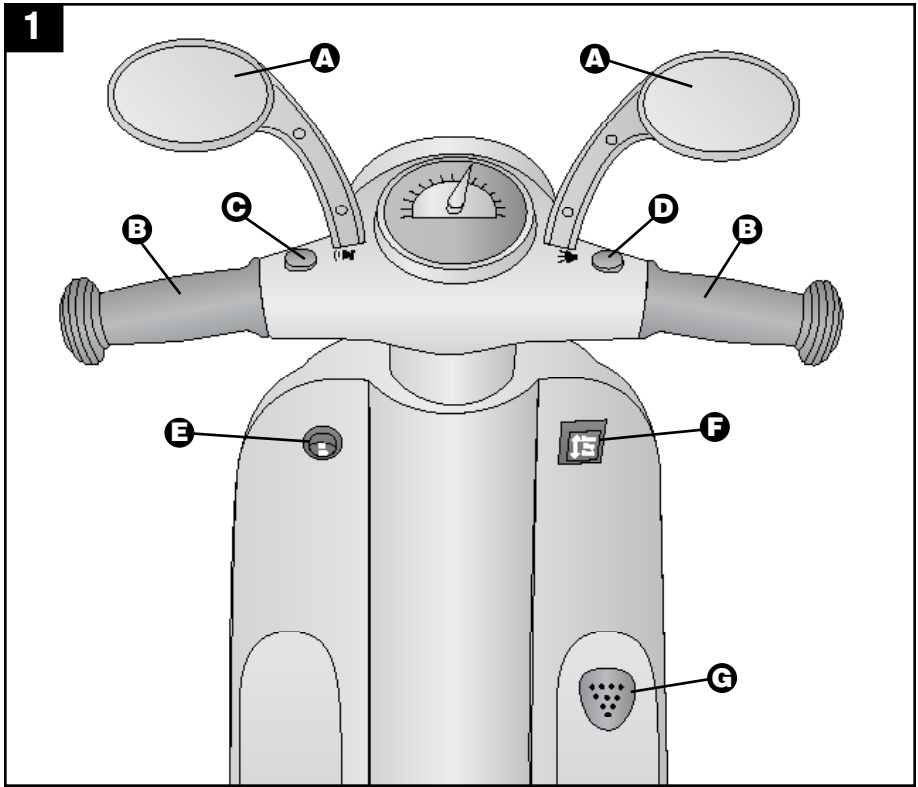

- A Rear view mirrors**
- B Handle grips**
- C Horn button** (Horn will sound when pressed)
- D Headlight button** (Headlight shines only when button is pressed.)
- E Power switch** (Rock switch up to turn the scooter on; rock switch down to turn off)
- F Shift switch**
(See instructions on page 11.)
- G Foot Pedal** (See instructions on page 11.)

Power Switch

A Power Switch

Turns the scooter on and off.

B ON

Rock the switch up turn the scooter on.

C OFF

Rock the switch down to turn the scooter off.

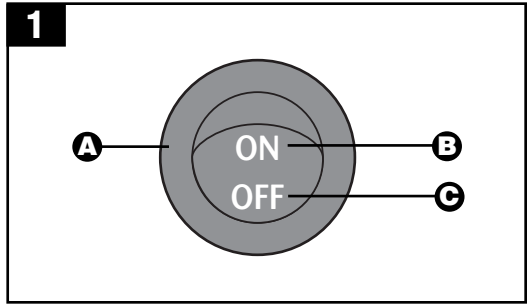

Shift Switch

IMPORTANT! The Sidekick Scooter MUST come to a complete stop before shifting into reverse. Damage to the gears and motor WILL occur. See page 12 for instructions on using the shifter and driving the Sidekick Scooter.

A Shift Switch

Controls forward motion
reverse gear

B Forward

Rock the switch up to go
forward at 2.5 mph (4 km/h)

C Reverse

Rock the switch down to go in
reverse at 2.5 mph (4 km/h)

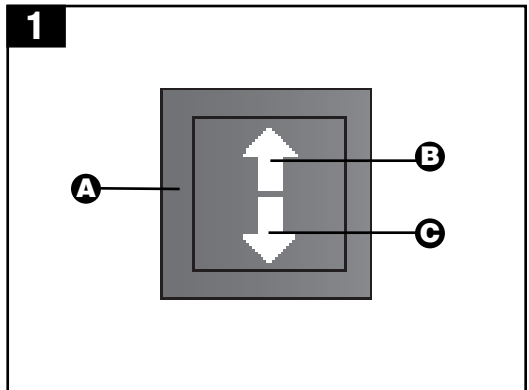

Foot Pedal

The foot pedal controls forward motion, reverse and stopping.

Forward/Reverse

Push down on the foot pedal, and the Sidekick Scooter will go forward or in reverse.

To Stop

Release the foot pedal.

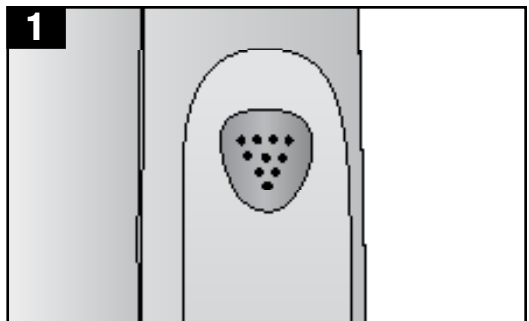

Driving the Sidekick Scooter

IMPORTANT! The Sidekick Scooter MUST come to a complete stop before shifting into reverse and into forward gear. Damage to the gears and motor WILL occur.

■ Forward

1. Rock the power switch up to turn the scooter on.
2. Rock the shift switch up to go forward.
3. Press down on the foot pedal, and the Sidekick Scooter will go forward at 2-1/2 mph (4 km/h).
4. Release the foot pedal, and the Sidekick Scooter will stop.

■ Reverse

1. Release the foot pedal to stop the Sidekick Scooter.
2. Rock the shift switch down to go in reverse.
3. Press down on the foot pedal, and the Sidekick Scooter will go in reverse at 2-1/2 mph (4 km/h).
4. Release the foot pedal, and the Sidekick Scooter will stop.

■ Stop

1. Release the foot pedal to stop the Sidekick Scooter.
2. If play is over for the day, turn the power switch to the "Off" position.

WARNING!

- **ALWAYS COME TO A COMPLETE STOP BEFORE GETTING OFF THE SCOOTER.**

Approximate Riding Time with a Fully-Charged Battery

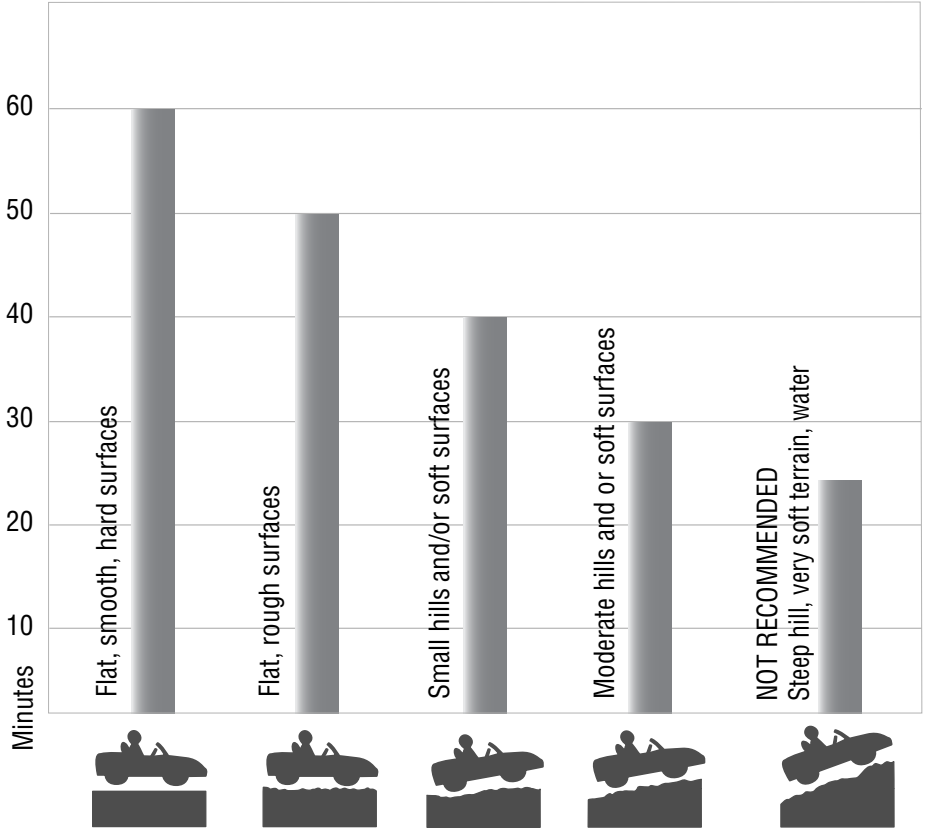

Battery Maintenance

IMPORTANT! READ AND UNDERSTAND THE WARNINGS ABOUT THE 6-VOLT BATTERY ON PAGE 6. ONLY ADULTS MAY HANDLE THE BATTERY!

- After each use, or once a month minimum, charge the battery for a full 16 hours. Do not leave the battery on the charger for more than 30 hours. See pages 5-7 for charging instructions.
- The Kid Trax Toys 6-volt battery will eventually lose the ability to hold a charge. Depending on the amount of use, and varying conditions, the battery should operate for one to three years.
- Do not leave the battery in the Sidekick Scooter for long periods of time unused. Battery may drain completely, causing permanent damage. Disconnect the battery connector from the battery.
- Handle the battery with care. Do not drop the battery. Permanent damage to the battery could occur.
- If the battery is removed from the Sidekick Scooter and stored, do not store the battery where temperatures are over 75° F (24° C) or under -10° F (-24° C). Do not place the battery directly on concrete for extended periods of time.
- It is best to leave the battery in the battery compartment of the vehicle for long storage periods. If you cannot do this or have a multiple batteries, please store the battery on a wood surface to avoid cement floor surface discharge. Always wipe the battery clean with a dry cloth prior to storage. You will still need to charge your battery once each month (16 hours) during long storage periods to ensure battery life.
- If the battery leaks or has completely discharged, it is no longer usable. Remove the battery according to the instructions on page 15 and place it in a plastic bag. See page 15 for disposal directions. Replace the battery with a Kid Trax Toys 6-volt battery ONLY. See page 20 to reorder parts.
- If the battery leaks, Do not allow acid from the battery to contact skin or eyes. If this happens, call your physician immediately. Flush with cool water for 15 minutes.
- If the battery leaks, Do not ingest acid. If this happens, call your physician immediately. Give water, milk of magnesia or egg whites. Do not induce vomiting.
- The Kid Trax Toys 6-volt battery features a thermal fuse with a reset fuse on the circuit board that will automatically trip and cut all power to the Sidekick Scooter if the motor, electric system or battery is overloaded. The fuse will reset and power will be restored after the unit is turned off and turned on again. If the thermal fuse trips repeatedly during normal use, your Sidekick Scooter may need repair. Call Kid Trax Toys Consumer Relations at (877) 741-6154 for an authorized service center. To avoid losing power, follow these guidelines:
 - Do not overload the Sidekick Scooter. Maximum weight allowed: 50 lbs. (22.7 kg).
 - Do not tow anything behind the Sidekick Scooter.
 - Do not drive up steep slopes.
 - Do not drive into fixed objects, which may cause the wheels to spin, causing the motor to overheat.
 - Do not drive in very hot weather; components may overheat.
 - Do not allow water or other liquids to come in contact with the battery or other electric components.
 - Do not tamper with the electric system. Doing so may create a short, causing the fuse to trip.

Replacing the Battery

The Kid Trax Toys 6-volt battery will eventually lose the ability to hold a charge. Depending on the amount of use, and varying conditions, the battery should operate for one to three years. If the battery will not recharge, you must obtain a new Kid Trax Toys 6-volt battery.

1. Using a Phillips screwdriver, unscrew the seat screw. **NOTE:** The screw will remain in the seat.
2. Lift seat off and set aside.
3. Unplug the battery connector from the battery.
4. Carefully lift the battery and set aside. **NOTE:** Never handle the battery by its connector or cables.

Recycle the dead battery responsibly. The battery contains lead acid (electrolyte) and must be disposed of properly and legally. **DO NOT** throw the battery away with your regular household trash! It is illegal in most areas to incinerate lead acid batteries or dispose of them in landfills. Take it to a federally or state-approved lead acid battery recycler, such as a Kid Trax Toys authorized service center or your local automotive battery retailer.

5. Replace the battery with a Kid Trax Toys 6-volt battery **ONLY**. Reconnect the battery connectors. Make sure the connection is tight.
6. Fit the tabs of the seat into the scooter body and press down. Tighten the seat screw using a Phillips screwdriver.

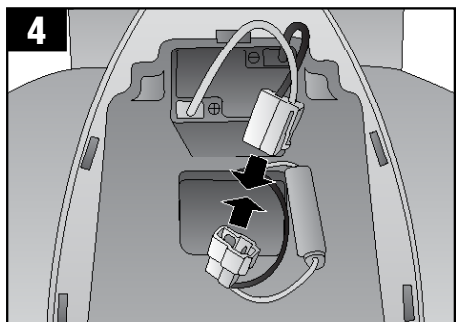
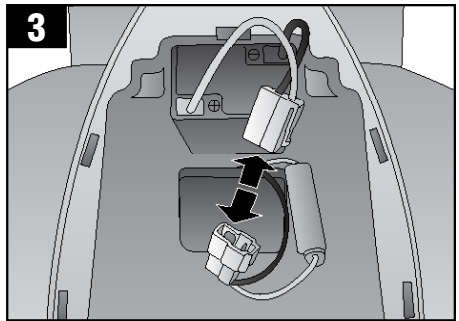
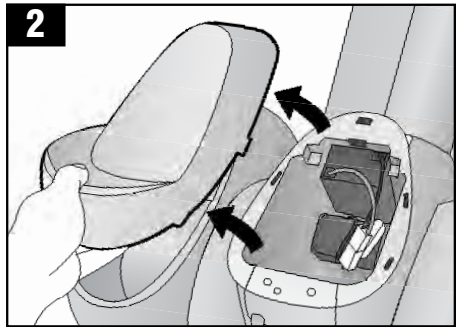
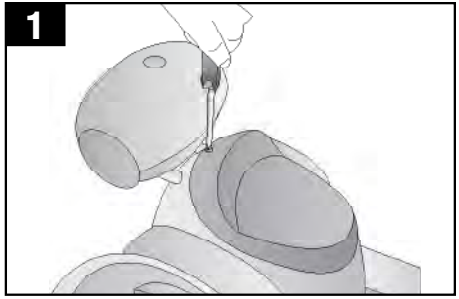

Maintaining Your Sidekick Scooter

- Periodically check to make sure the seat screw and wheel nuts are tight.
- Make sure the plastic parts of the Sidekick Scooter are not cracked or broken.
- Occasionally use a lightweight oil to lubricate moving parts such as wheels.
- Park the Sidekick Scooter indoors or cover it with a tarp to protect it from wet weather.
- Keep the Sidekick Scooter away from sources of heat, such as stoves and heaters. Plastic parts may melt.
- Recharge the battery after each use. Only an adult can handle the battery. Recharge the battery at least once a month when the Sidekick Scooter is not being used. See pages 5-7 for instructions about recharging the battery.
- Do not wash the Sidekick Scooter with a hose. Do not wash the Sidekick Scooter with soap and water. Do not drive the Sidekick Scooter in rainy or snowy weather. Water will damage the motor, electric system and battery.
- Clean the Sidekick Scooter with a soft, dry cloth. To restore shine to plastic parts, use a non-wax furniture polish. Do not use car wax. Do not use abrasive cleaners.
- Do not drive the Sidekick Scooter in loose dirt, sand or fine gravel, which could damage moving parts, motors or the electric system.
- Kid Trax Toys recommends that you take your Sidekick Scooter to an authorized service center for periodic maintenance and service. Call Kid Trax Toys Consumer Relations at (877) 741-6154 for an authorized service center.

Troubleshooting Guide

Having problems with your Sidekick Scooter? Read through this troubleshooting guide for solutions to common problems. If you still experience problems, call Kid Trax Toys Consumer Relations at (877) 741-6154 for an authorized service center.

- Kid Trax Toys recommends that you take your Sidekick Scooter to an authorized service center for periodic maintenance and service. Call Kid Trax Toys Consumer Relations at (877) 741-6154 for an authorized service center.

■ **PROBLEM: The Sidekick Scooter does not run.**

POSSIBLE CAUSE: The battery may be low on power.

After each use, or once a month minimum, charge the battery for a full 16 hours. Do not leave the battery on the charger for more than 30 hours. See pages 5-7 for recharging warnings and instructions.

POSSIBLE CAUSE: Thermal fuse has tripped.

The Kid Trax Toys 6-volt battery features a thermal fuse with a reset fuse on the circuit board that will automatically trip and cut all power to the Sidekick Scooter if the motor, electric system or the battery is overloaded. The fuse will reset after the unit is turned off and then on again. See page 14 for tips to avoid tripping the thermal fuse.

POSSIBLE CAUSE: Wheel nuts are loose.

If the nuts are not tight, the front wheel will not engage the forward gears. Tighten both the nuts with the nut wrenches supplied.

POSSIBLE CAUSE: Battery connector or wires are loose.

Make sure the battery connectors are firmly plugged into each other. If you find loose wires around the motor, call Kid Trax Toys Consumer Relations at (877) 741-6154 for an authorized service center.

POSSIBLE CAUSE: Battery is dead.

Have you properly maintained the battery according to the directions? Is the battery old? Your battery may need to be replaced. Refer to the Battery Maintenance instructions on page 14.

POSSIBLE CAUSE: Electric system is damaged.

Water may have corroded the system, or loose dirt, gravel or sand might have jammed the switch. Call Kid Trax Toys Consumer Relations at (877) 741-6154 for an authorized service center.

POSSIBLE CAUSE: Motor is damaged.

The Sidekick Scooter needs professional repair. Call Kid Trax Toys Consumer Relations at (877) 741-6154 for an authorized service center.

Troubleshooting Guide

■ **PROBLEM: The 6-volt battery will not recharge.**

POSSIBLE CAUSE: Battery connector or adapter connector is loose.

Make sure the battery connector and the adapter connector are firmly plugged together.

POSSIBLE CAUSE: Charger is not plugged in.

Make sure the charger is plugged into the wall outlet and the power flow to the outlet is on.

POSSIBLE CAUSE: Charger is not working.

The charger may be broken and may need to be replaced. Call Kid Trax Toys Consumer Relations at (877) 741-6154 for an authorized service center.

■ **PROBLEM: The Sidekick Scooter does not run very long.**

POSSIBLE CAUSE: Battery may be undercharged.

Make sure the battery connectors are firmly plugged into each other.

POSSIBLE CAUSE: Charger is not plugged in.

You may not be charging the battery long enough. After each use, or once a month minimum, charge the battery for 6 to 8 hours. Do not leave the battery on the charger for more than 30 hours. See pages 5-7 for recharging warnings and instructions.

POSSIBLE CAUSE: Battery is old.

The Kid Trax Toys 6-volt battery will eventually lose the ability to hold a charge. Depending on the amount of use, and varying conditions, the battery should operate for one to three years. Replace the battery with a new Kid Trax Toys 6-volt battery. See page 20 to reorder parts.

■ **PROBLEM: Battery buzzes or gurgles when charging.**

This is normal and not a cause for concern. It may also be silent when charging, which is also normal.

■ **PROBLEM: Charger feels warm when recharging battery.**

This is normal and not a cause for concern.

Troubleshooting Guide

■ **PROBLEM: The Sidekick Scooter runs sluggishly.**

POSSIBLE CAUSE: Battery needs recharging.

After each use, or once a month minimum, charge the battery for 6 to 8 hours. Do not leave the battery on the charger for more than 30 hours. Low battery signal will sound when the battery is running low on power. See pages 5-7 for charging warnings and instructions.

POSSIBLE CAUSE: Battery is old.

The Kid Trax Toys 6-volt battery will eventually lose the ability to hold a charge. Depending on the amount of use, and varying conditions, the battery should operate for one to three years. Replace the battery with a new Kid Trax Toys 6-volt battery. See page 20 to reorder parts.

POSSIBLE CAUSE: Sidekick Scooter is overloaded.

Maximum combined weight is 50 lbs. (22.7 kg). Do not overload the Sidekick Scooter. Do not tow anything behind the Sidekick Scooter.

POSSIBLE CAUSE: Driving in harsh conditions.

Drive only on level ground. The Sidekick Scooter will operate best on concrete or other firm surfaces. Do not drive up or down steep slopes, in mud or on loose dirt or gravel.

■ **PROBLEM: Difficulty shifting forward or into reverse.**

POSSIBLE CAUSE: Trying to shift while the Sidekick Scooter is moving.

The Sidekick Scooter MUST come to a complete stop before shifting forward or into reverse. Damage to the gears and motor WILL occur.

■ **PROBLEM: Loud grinding or clicking noises coming from motor or gear box.**

POSSIBLE CAUSE: Gears are stripped or broken.

The Sidekick Scooter needs professional repair. Call Kid Trax Toys Consumer Relations at (877) 741-6154 for an authorized service center.

■ **PROBLEM: Sidekick Scooter needs a push to go forward.**

POSSIBLE CAUSE: Poor contact of wires or connectors.

Make sure the battery connector is firmly plugged into the battery. Check for loose wires around the motor and reconnect if necessary.

POSSIBLE CAUSE: "Dead spot" on motor.

A "dead spot" means the electric power is not being delivered to the terminal connection. The Sidekick Scooter needs professional repair. Call Kid Trax Toys Consumer Relations at (877) 741-6154 for an authorized service center.

Replaceable Parts

- Front wheel
- Front wheel axle assembly
- Front wheel hub caps
- Rear wheel hub caps
- Seat
- 6-volt battery
- Charger

To order parts call (877) 741-6154.

Provide the serial number, found underneath the Sidekick Scooter's seat on the car body and a brief description of the part.

One-Year Limited Warranty

Six-Month Limited Warranty on Battery

Pacific Cycle, Inc. (PC) warrants this product to the original retail purchaser as follows:

The vehicle (except for the 6-volt battery) is warranted against defective materials or workmanship for one year from the date of original purchase. The 6-volt battery is warranted against defective materials or workmanship for six months from the date of original purchase. **An original receipt is required to validate your warranty.** PC will, at its option, provide replacement parts or replace this product. PC reserves the right to substitute if the part or model has been discontinued.

To make a claim under this warranty you may contact us at www.kidtraxtoys.com; fax us at 1-800-207-8182, 24 hours a day; write to Kid Trax Consumer Relations Department, Kid Trax Toys, P.O. Box 344 Olney, IL 62450 or call 1-877-741-6154 from 8 a.m. to 5 p.m., Monday through Friday, CST. **Proof of purchase is required, and shipping charges are the responsibility of the consumer.**

Warranty Limitations:

This warranty does not include damages which arise from accident, misuse, abuse, neglect or other causes not arising out of defects in materials or workmanship, nor does it cover damages arising out of service by other than an authorized PC service center. For personal use only. Not for commercial use.

The original owner shall pay all labor charges connected with the repair or replacement of all parts. Under no circumstances does this limited warranty include the cost of shipment or transportation to or from an authorized Kid Trax repair center or Kid Trax retailer.

Limitation of Damages:

The warranty and remedies as set forth are exclusive and in lieu of all others, oral or written, expressed or implied. In no event will PC or the dealer selling this product be liable to you for any damages, including incidental or consequential damages, arising out of the use or inability to use this product. Some states do not allow limitations as the exclusion or limitation of incidental or consequential damages, so the above limitation may not apply to you.

Limitation of warranties and other warranty terms:

Any implied warranties, including implied warranties of the merchantability and fitness for a particular purpose, shall be limited to the duration and terms of the express written warranty. Some states do not allow limitations as the exclusion or limitation of incidental or consequential damages, so the above limitation may not apply to you. This warranty gives you specific legal rights, and you may have other rights, which vary from state to state. Neither PC nor the dealer selling this product authorized any person to create for it any other warranty, obligation or liability in connection with this product.

